



Create your own customized nameplates with the flexibility of changeable signs.

Choose the style and color that match your décor. Magnetic nameplates snap easily in and out of sign frames, allowing you to change your nameplates as your needs change.



Please write the frame Model No. on the order form (page 44). Nameplates are sold separately on page 41.

Frame Colors

Please write the frame color code on the order form (page 44).

Gray Frame (01)

Black Frame (04)

Bronze Frame (93)

Square Frames

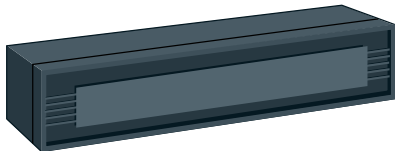

DESK BAR

Size: 9"W x 2"H x 1-3/8"D
Model No. 2837042F



REVERSIBLE TELLER BARS

Size: 9"W x 2"H x 1-3/8"D
"Next Teller Please" Model No. 2837044T
"Next Window Please" Model No. 2837046W



WALL SIGN

Size: 9"W x 2"H x 3/8"D
Model No. 2837048F



DESK PEDESTAL

Size: 9"W x 2"H x 3/8"D
Model No. 2837050F04 - Available in Black only

Radius Frames



DESK BAR

Size: 9"W x 2"H x 1-3/8"D
Model No. 2837043F



REVERSIBLE TELLER BARS

Size: 9"W x 2"H x 1-3/8"D
"Next Teller Please" Model No. 2837045T
"Next Window Please" Model No. 2837047W



WALL SIGN

Size: 9"W x 2"H x 3/8"D
Model No. 2837049F



DESK PEDESTAL

Size: 9"W x 2"H x 3/8"D
Model No. 2837061F04 - Available in Black only



Mounting Options

To choose a mounting option, please check the appropriate box on page 44.

FOR DESK BARS AND DESK PEDESTALS



CORK BASE (Standard)

A non-slip, rubberized cork base will be supplied unless otherwise specified. No extra charge.



DOUBLE-FACED ADHESIVE (Optional)

For semi-permanent mounting, a double-coated adhesive may be requested instead of the cork base. No extra charge.

FOR WALL SIGNS



DOUBLE-FACED ADHESIVE TAPE (Standard)

A double-coated adhesive for semi-permanent mounting will be supplied unless otherwise specified.

BACKING WITH HOOK AND LOOP FASTENER (Optional) Supplied in place of adhesive upon request. No extra charge.

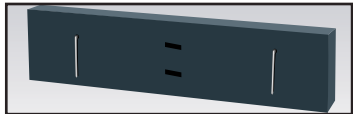

DOUBLE-PIN MOUNTS (Optional)

Two pins on sign back easily slip into cloth surfaces. Model No. 283700100

NAMEPLATE DIMENSIONS

Square / Radius Full Nameplate – 8-11/16"W x 1-3/4"H

Split Nameplate – 8-11/16"W x 7/8"H

2/3 Nameplate – 5-13/16" W x 1-3/4"H

2/3 Split Nameplate – 5-13/16"W x 7/8"H

1/3 Nameplate – 2-7/8"W x 1-3/4"H

BLANK NAMEPLATES

Add "B" as suffix to nameplate Model No. before adding nameplate color code.

CUSTOM LOGOS

All changeable signs can be personalized with your company logo. Custom logos will be silk-screened to fit your custom nameplate.

Model No.	Description
283900100	Custom Logo Screen Charge

Subsurface-Engraved Nameplates

Imprint is reverse-engraved, then covered with a blended acrylic material providing a smooth surface for a tough, long-lasting sign.

SQUARE NAMEPLATES



2836095 Square Nameplate

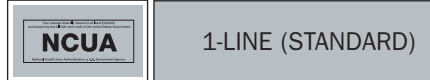

2836079N NCUA 1/3 Nameplate
2836097 2/3 Combination Nameplate



2836080N FDIC 1/3 Nameplate
2836097 2/3 Combination Nameplate

RADIUS NAMEPLATES



2836082 Radius Nameplate



2836088N NCUA Nameplate

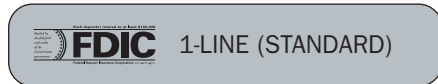

2836087N FDIC Nameplate

Model No.	Description
28366600	Additional Line of Copy Subsurface-Engraved

Engraved Nameplates

Imprint is etched on the front of the Nameplate for a clean, textured look.



2838095 Square Nameplate



2838079N NCUA 1/3 Nameplate
2838097 2/3 Combination Nameplate



2838080N FDIC 1/3 Nameplate
2838097 2/3 Combination Nameplate

Model No.	Description
28188800	Additional Line of Copy - Engraved

Vinyletter™ Nameplates

Stick-on letters are precision cut from vinyl and evenly spaced on injection-molded plastic nameplate.

SQUARE NAMEPLATES

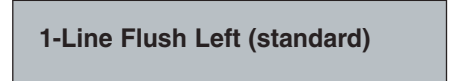

2837095 Square Nameplate

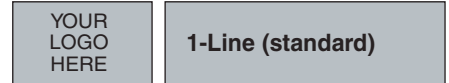

2837081 Custom 1/3 Nameplate
Min. order 10 each

2837097 2/3 Combination Nameplate



2837079N NCUA 1/3 Nameplate
2837097 2/3 Combination Nameplate



2837080N FDIC 1/3 Nameplate
2837097 2/3 Combination Nameplate

SQUARE SPLIT NAMEPLATES

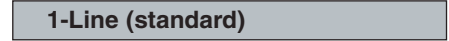
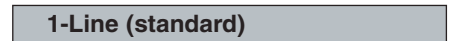

2837098 Full Length Split Nameplates
(2 required to complete sign)

RADIUS NAMEPLATES

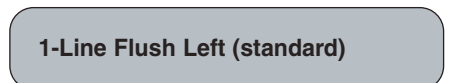

2837082 Radius Nameplate

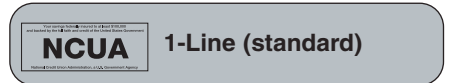

2837088N NCUA Nameplate

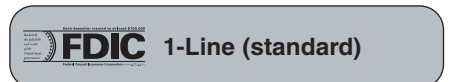

2837087N FDIC Nameplate

Model No.	Description
28377700	Additional Line of Copy - Vinyletter



Add the nameplate Model No. to the Order Form (page 44). See page 43 for choice of nameplate colors.